



KEY

- PROPOSED DISABLED PARKING BAY - NO TIME LIMIT
- EXISTING WAITING, LOADING AND PARKING RESTRICTIONS (WITH OR WITHOUT SYMBOLS)

Notes

0	50	100	200
---	----	-----	-----

Rev.	Description	Drwn	Sig.	Date	Chkd	Sig.	Date	Appr	Sig.	Date
A	WAITING RESTRICTIONS AMENDED	SDC	SDC	29.07.08	SDC	SDC	29.07.08	TPC	TPC	29.07.08
B	RESTRICTIONS AMENDED	CAH	CAH	11.11	JAR	JAR	11.11	TPC	TPC	11.11

North Point

Drawn by	Sig.	Date
SDC	SDC	05/05

Checked by	Sig.	Date
AM	AM	05/05

Approved by	Sig.	Date
TPC	TPC	05/05

Project
OLD WOKING DPE WOKING

Implemented Traffic Orders

SHEET 32 of 101

SURREY COUNTY COUNCIL
Sustainable Development

Project No.	3282/WOK
Contract Sheet No.	
Drawing No.	20032
Rev.	C
Classification	PROPOSAL

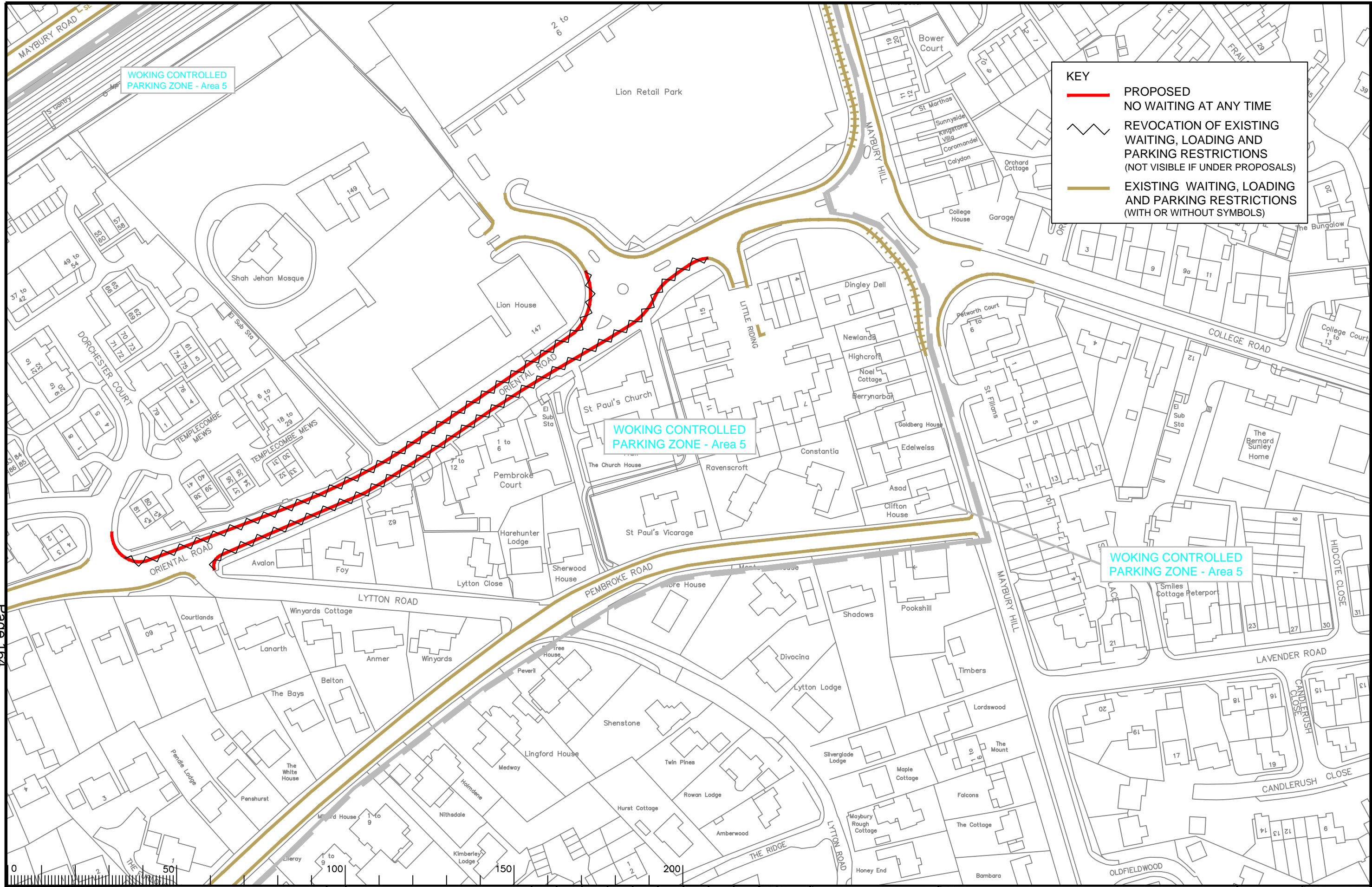

WOKING CONTROLLED PARKING ZONE - Area 5

WOKING CONTROLLED PARKING ZONE - Area 5

WOKING CONTROLLED PARKING ZONE - Area 5

KEY

- PROPOSED NO WAITING AT ANY TIME
- ~ REVOCATION OF EXISTING WAITING, LOADING AND PARKING RESTRICTIONS (NOT VISIBLE IF UNDER PROPOSALS)
- EXISTING WAITING, LOADING AND PARKING RESTRICTIONS (WITH OR WITHOUT SYMBOLS)

Notes

Rev.	Description	Drwn	Sig.	Date	Chkd	Sig.	Date	Appr	Sig.	Date
A	LINESTYLES AMENDED	AJM	AJM	12.12.07	KP	KP	12.12.07	TPC	TPC	12.12.07
B	WAITING RESTRICTIONS AMENDED	SDC	SDC	29.07.08	SDC	SDC	29.07.08	TPC	TPC	29.07.08
C	RESTRICTIONS AMENDED	CAH	CAH	05.13	JAR	JAR	05.13	RH	RH	05.13
D	RESTRICTIONS AMENDED	CAH	CAH	02.17	PW	PW	02.17	RH	RH	02.17

Drwn	Sig.	Date	Chkd	Sig.	Date	Appr	Sig.	Date
AJM	AJM	12.12.07	KP	KP	12.12.07	TPC	TPC	12.12.07
SDC	SDC	29.07.08	SDC	SDC	29.07.08	TPC	TPC	29.07.08
CAH	CAH	05.13	JAR	JAR	05.13	RH	RH	05.13
CAH	CAH	02.17	PW	PW	02.17	RH	RH	02.17

Scale 1:1250

North Point

Based upon the Ordnance Survey mapping with the permission of the Controller of Her Majesty's Stationery Office. Crown copyright. Unauthorised reproduction infringes Crown copyright and may lead to prosecution or civil proceedings. Surrey County Council LA 076872 1996.

Drawn by	Sig.	Date	Checked by	Sig.	Date	Approved by	Sig.	Date
SDC	SDC	05/05	AM	AM	05/05	TPC	TPC	05/05

Project: WOKING DPE WOKING

Implemented Traffic Orders

SHEET OF

Project No. 3282/WOK

Contract Sheet No. 20077

Rev. D

Classification: PROPOSAL

SURREY COUNTY COUNCIL
Sustainable Development

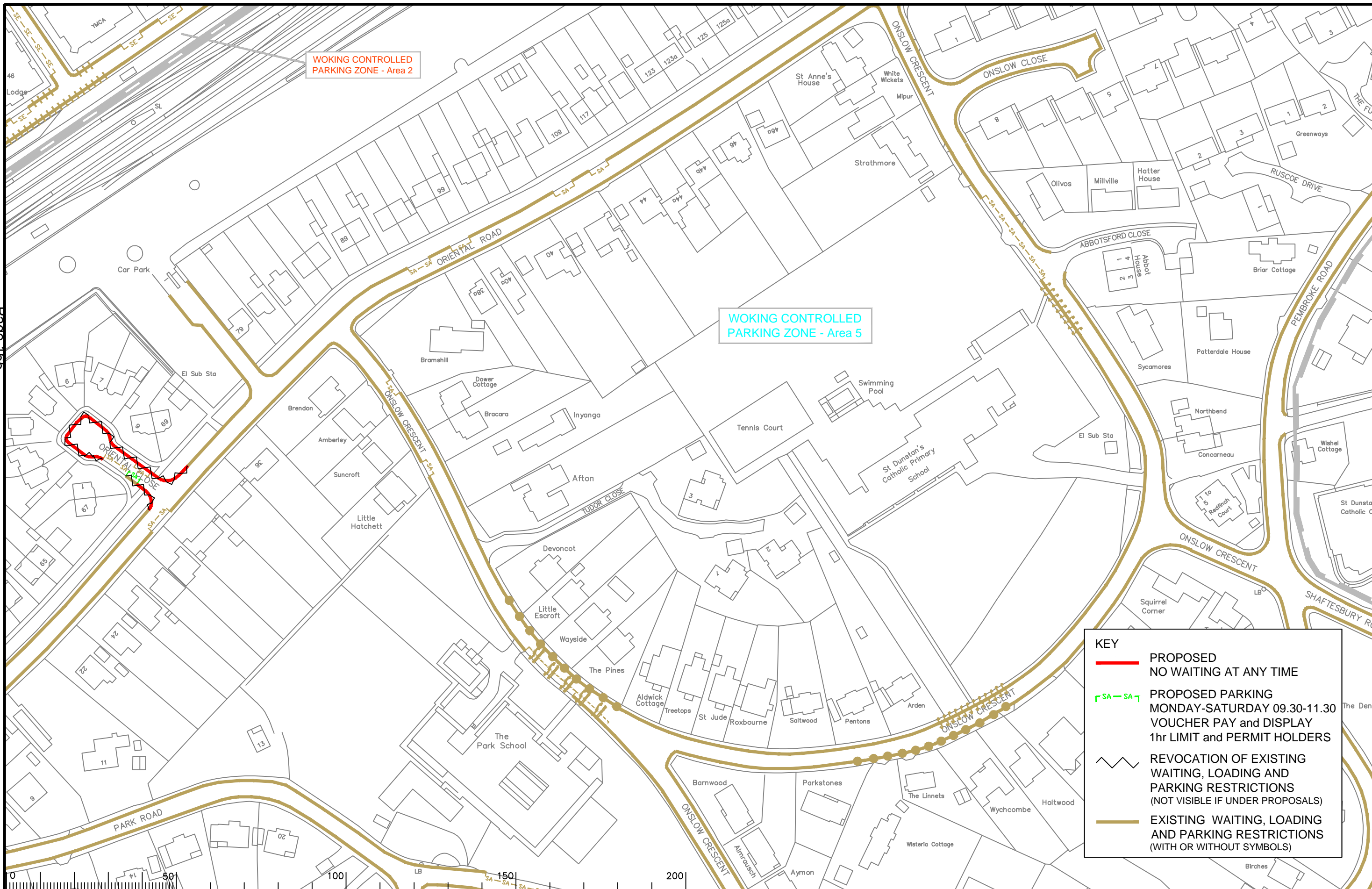

KEY

- PROPOSED NO WAITING AT ANY TIME
- - - SA - SA - - - PROPOSED PARKING MONDAY-SATURDAY 09.30-11.30 VOUCHER PAY and DISPLAY 1hr LIMIT and PERMIT HOLDERS
- REVOCATION OF EXISTING WAITING, LOADING AND PARKING RESTRICTIONS (NOT VISIBLE IF UNDER PROPOSALS)
- EXISTING WAITING, LOADING AND PARKING RESTRICTIONS (WITH OR WITHOUT SYMBOLS)

Notes

0	50	100	150	200
---	----	-----	-----	-----

Rev.	Description	Drwn	Sig.	Date	Chkd	Sig.	Date	Appr	Sig.	Date
A	Changes to Onslow Crescent	SDC	SDC	12.12.06	GT	GT	12.12.06	TPC	TPC	12.12.06
B	LINESTYLES AMENDED	AJM	AJM	12.12.07	KP	KP	12.12.07	TPC	TPC	12.12.07
C	RESTRICTIONS AMENDED	CAH	CAH	11.11	PW	PW	11.11	TPC	TPC	11.11
D	RESTRICTIONS AMENDED	CAH	CAH	2013	JAR	JAR	2013	RH	RH	2013
E	RESTRICTIONS AMENDED	CAH	CAH	05.13	JAR	JAR	05.13	RH	RH	05.13
F	RESTRICTIONS AMENDED	CAH	CAH	08.14	PW	PW	08.14	RH	RH	08.14
G	RESTRICTIONS AMENDED	CAH	CAH	11.15	PW	PW	11.15	RH	RH	11.15
H	RESTRICTIONS AMENDED	CAH	CAH	02.17	PW	PW	02.17	RH	RH	02.17

North Point

Based upon the Ordnance Survey mapping with the permission of the Controller of Her Majesty's Stationery Office. Crown copyright. Unauthorised reproduction infringes Crown copyright and may lead to prosecution or civil proceedings. Surrey County Council LA 076872 1996.

Drawn by	SDC	Sig.	SDC	Date	05/05
Checked by	AM	Sig.	AM	Date	05/05
Approved by	TPC	Sig.	TPC	Date	05/05

Project
WOKING DPE
WOKING

Implemented Traffic Orders

SHEET OF

SURREY COUNTY COUNCIL
Sustainable Development
Head of Transportation
Roadway Design Unit

Project No. 3282/WOK
Contract Sheet No. 20081
Drawing No. 20081
Rev. H
Classification: PROPOSAL

WOKING CONTROLLED PARKING ZONE - Area 5

KEY

- PROPOSED NO WAITING AT ANY TIME
- SA SA PROPOSED PARKING MONDAY-SATURDAY 09.30-11.30 VOUCHER PAY and DISPLAY 1hr LIMIT and PERMIT HOLDERS
- REVOCATION OF EXISTING WAITING, LOADING AND PARKING RESTRICTIONS (NOT VISIBLE IF UNDER PROPOSALS)
- EXISTING WAITING, LOADING AND PARKING RESTRICTIONS (WITH OR WITHOUT SYMBOLS)

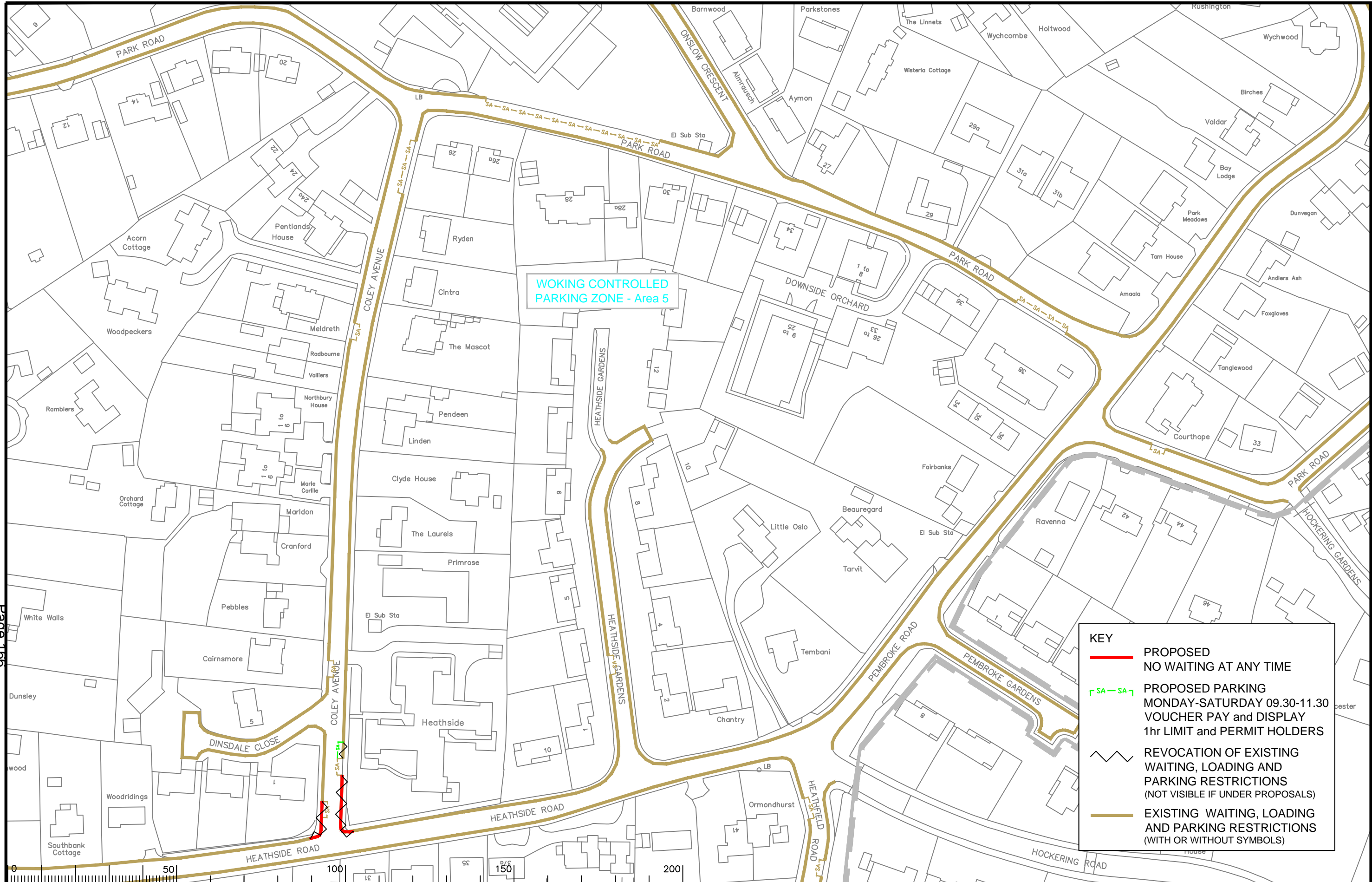

Page 166

Notes

Rev.	Description	Drwn	Sig.	Date	Chkd	Sig.	Date	Appr	Sig.	Date
A	Changes to Park Road, Coley Avenue, Heathside Gardens	SDC	SDC	12.12.06	GT	GT	12.12.06	TPC	TPC	12.12.06
B	WAITING RESTRICTIONS & LINETYPES AMENDED	AJM	AJM	18.12.07	KP	KP	18.12.07	TPC	TPC	18.12.07
C	RESTRICTIONS AMENDED	CAH	CAH	11.11	PW	PW	11.11	TPC	TPC	11.11
D	RESTRICTIONS AMENDED	CAH	CAH	2013	JAR	JAR	2013	RH	RH	2013
E	RESTRICTIONS AMENDED	CAH	CAH	05.13	JAR	JAR	05.13	RH	RH	05.13
F	RESTRICTIONS AMENDED	CAH	CAH	08.14	PW	PW	08.14	RH	RH	08.14
G	RESTRICTIONS AMENDED	CAH	CAH	11.15	PW	PW	11.15	RH	RH	11.15
H	RESTRICTIONS AMENDED	CAH	CAH	02.17	PW	PW	02.17	RH	RH	02.17

Rev.	Description	Drwn	Sig.	Date	Chkd	Sig.	Date	Appr	Sig.	Date
A	Changes to Park Road, Coley Avenue, Heathside Gardens	SDC	SDC	12.12.06	GT	GT	12.12.06	TPC	TPC	12.12.06
B	WAITING RESTRICTIONS & LINETYPES AMENDED	AJM	AJM	18.12.07	KP	KP	18.12.07	TPC	TPC	18.12.07
C	RESTRICTIONS AMENDED	CAH	CAH	11.11	PW	PW	11.11	TPC	TPC	11.11
D	RESTRICTIONS AMENDED	CAH	CAH	2013	JAR	JAR	2013	RH	RH	2013
E	RESTRICTIONS AMENDED	CAH	CAH	05.13	JAR	JAR	05.13	RH	RH	05.13
F	RESTRICTIONS AMENDED	CAH	CAH	08.14	PW	PW	08.14	RH	RH	08.14
G	RESTRICTIONS AMENDED	CAH	CAH	11.15	PW	PW	11.15	RH	RH	11.15
H	RESTRICTIONS AMENDED	CAH	CAH	02.17	PW	PW	02.17	RH	RH	02.17

Based upon the Ordnance Survey mapping with the permission of the Controller of Her Majesty's Stationery Office © Crown copyright. Unauthorised reproduction infringes Crown copyright and may lead to prosecution or civil proceedings. Surrey County Council LA 076872 1996.

Checked by	Sig.	Date
SDC	SDC	05/05
AM	AM	05/05
ADVERTISED	TPC	05/05

Project: WOKING DPE WOKING

Implemented Traffic Orders

SHEET OF

SURREY COUNTY COUNCIL
Sustainable Development

Project No. 3282/WOK
Contract Sheet No. 20087
Drawing No. H
Classification: PROPOSAL